



Your Complimentary Program Guide and Site Map
33rd Annual Australian Heritage Festival
22nd – 30th August 2009

DAILY EVENTS THROUGH-OUT THE WHOLE FESTIVAL

- Felting, Spinning (Area 2)
- Weaving, Knitting (Area 2)
- Horse Drawn Wagon Rides (Area 35)
- Miniature Train Rides (Area 37)
- Rope-making (Area 14)
- Bar from 10:00am (Area 38)
- Farm yard babies (Area 35)
- Craft Stalls (Area 21)
- Machinery Displays (Area 22-29)
- Blacksmithing (Area 11)
- Billy Tea & Damper Hut (Area 19)

ERGON ENERGY SPORTSHEAR QLD CHAMPIONSHIPS:

- Saturday 29th August
- Finals from 3:30pm
- In the Woolshed (Area 2)

WORKING DOG TRIALS:

- Sat. 22 & Sun. 23 August
- Fri. 28 to Sun. 30 August
- At Sheep Dog Arena (Area 36)

EVENING PROGRAM

SATURDAY NIGHT DANCES:

- 22 & 29 August
- Gold coin entry
- Doors open 6:30pm
- BBQ at extra cost
- Bar open
- Band starts 7:30pm

MEALS & REFRESHMENTS

- Meals available for purchase at the Cookhouse
- From 6:00pm to 7:30pm

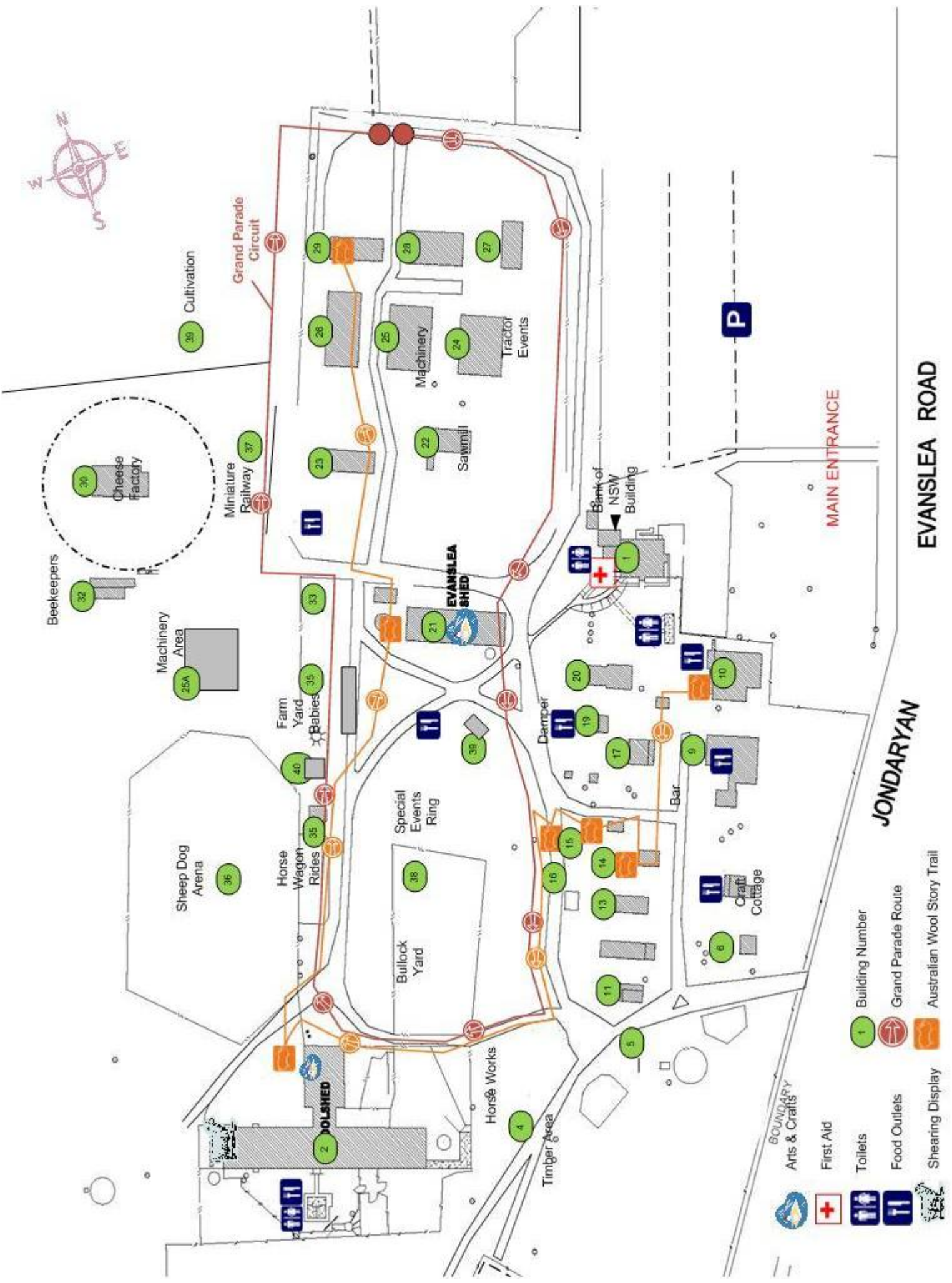

Principal Sponsor



Foundation Sponsors





GATES OPEN AT 9:00am

Things to see on the hour, every hour:



THINGS TO SEE AT 10:00am

Tunisian Crochet (Area 2)

Cheese making (Area 30)

THINGS TO SEE AT 11:00am

Crochetnit (Area 2)

THINGS TO SEE AT 12:00pm

Beekeeping/Honey (Area 32)

THINGS TO SEE AT 1:00pm

Cheese making (Area 30)

THINGS TO SEE AT 2:00pm

Whip-cracking demos (Area 15)

Locker Hooking (Area 2)

Aust. Cinematic History (Area 9)

School's In (Area 17) (Wkends only)

THINGS TO SEE AT 3:00pm

Locker Hooking (Area 2)

***PLEASE NOTE: *Shearing on Sat. 22 Aug 10:30am will be starting at 11:15am due to Official Opening taking place in the Woolshed (Area 2)**

THE MAIN EVENTS

9:00am & 2:30pm

Join us while we milk the house cow... then, just like 100 years ago, we'll separate the milk from the cream and hand churn some fresh butter (Takes approx. 30mins). **GO TO AREA 33**

10:00am & 2:30pm

A complete guided tour of the machinery and horse-drawn farming area. Everything from road making, saw milling, rock crushing, threshing, hay baling, chaff cutting, house moving to weird ways of starting old tractors and a demo of the unique Aust. Stump Jump Plough (Takes approx 1hr) **GO TO AREA 22**

THIS IS A TOUR DESIGNED FOR EVERYBODY YOU DON'T HAVE TO BE A MACHINERY BUFF TO LOVE THIS!!

10:30am* & 1:30pm

The reason we are all here! Shearing in our beautiful heritage listed Woolshed. Not just shearing though, but a demo of everything to do with wool and shearing. Everything from shearing to wool classing to wool pressing, meet the people who make it all happen, listen to a few good yarns & have a look at all the things we do with wool! (Takes approx 1hr) **GO TO AREA 2**

11:00am & 1:00pm

Wagon wheel tiring at the Station Smithy. Come and see how they fitted the iron tyres to the wooden wagon wheels. Watch 'em make horse shoes and other iron ware in the forge (Takes approx. 30mins). **GO TO AREA 11**

LUNCH (see map)

There are food outlets all over the grounds, BUT the best place to be is at the food and entertainment court! Sit and enjoy lunch while watching rope making or sheep dogs working and listening to some great music. (Dinner and a show!)

12:30pm

THE GRAND PARADE

The biggest and best in the land! Sit anywhere on the side of the track, get your camera out and limber up your waving arm. This is the best Grand Parade you will see anywhere in Australia! The voice behind this year's Grand Parade is Barry Geitz.

Contact us:

264 Evanslea Rd, Jondaryan, QLD 4403

Ph: (07) 4692 2229 Fax: (07) 4692 2220

Email: info@jondaryanwoolshed.com Web: www.jondaryanwoolshed.com

The Australian Heritage Festival acknowledges the generous assistance received from our valued Sponsors

Things to see every hour, on the half hour:

THINGS TO SEE AT 9:30am

Tunisian Crochet (Area 2)

Aust. Cinematic History (Area 9)

THINGS TO SEE AT 10:30am

Tunisian Crochet (Area 2)

School's In (Area 17)

Beekeeping/Honey (Area 32)

THINGS TO SEE AT 11:30am

Whip-cracking demos/comps (Area 15)

Crochetnit (Area 2)

Empire Theatres Performance (Area 17)

Cheese making (Area 30)

THINGS TO SEE AT 1:30pm

Locker Hooking (Area 2)

Empire Theatres Performance (Area 17)

Beekeeping/Honey (Area 32)

THINGS TO SEE AT 2:30pm

Locker Hooking (Area 2)

Machinery Tour (Area 22)

Saw milling and Tractor

Starting (Area 22)

THINGS TO SEE AT 3:30pm

Locker Hooking (Area 2)

DAILY PROGRAM FINISHES AT 4:00pm

Times & Displays subject to change



LOT FEEDERS PTY LTD
GUARANTEED EXCELLENCE



everything in our power



Wilson HTM
INVESTMENT GROUP



Australian Government
Festivals Australia

